

Introducing Advanced Typography: Glyph Picker, Default Font Setting and Font Ordering

We've introduced a set of typography controls that let a brand use its own font fully inside the Pencil editor: applying a font's special glyphs from a picker, controlling how fonts are ordered, and defaulting new text to the brand font.

Until now, a font's special characters (e.g. ™®©) could only be added through copy/paste or remembering Mac option-key shortcuts. New text didn't start in the brand font, and a brand's fonts weren't surfaced at the top of the font list. Staying on-brand meant selecting the right font by hand every time and, sometimes, finishing the typography in another program like Photoshop after the fact.

Now we have a glyph picker and workspace-level font controls in Pencil, so brand-compliant creatives can more easily be produced directly in Pencil.

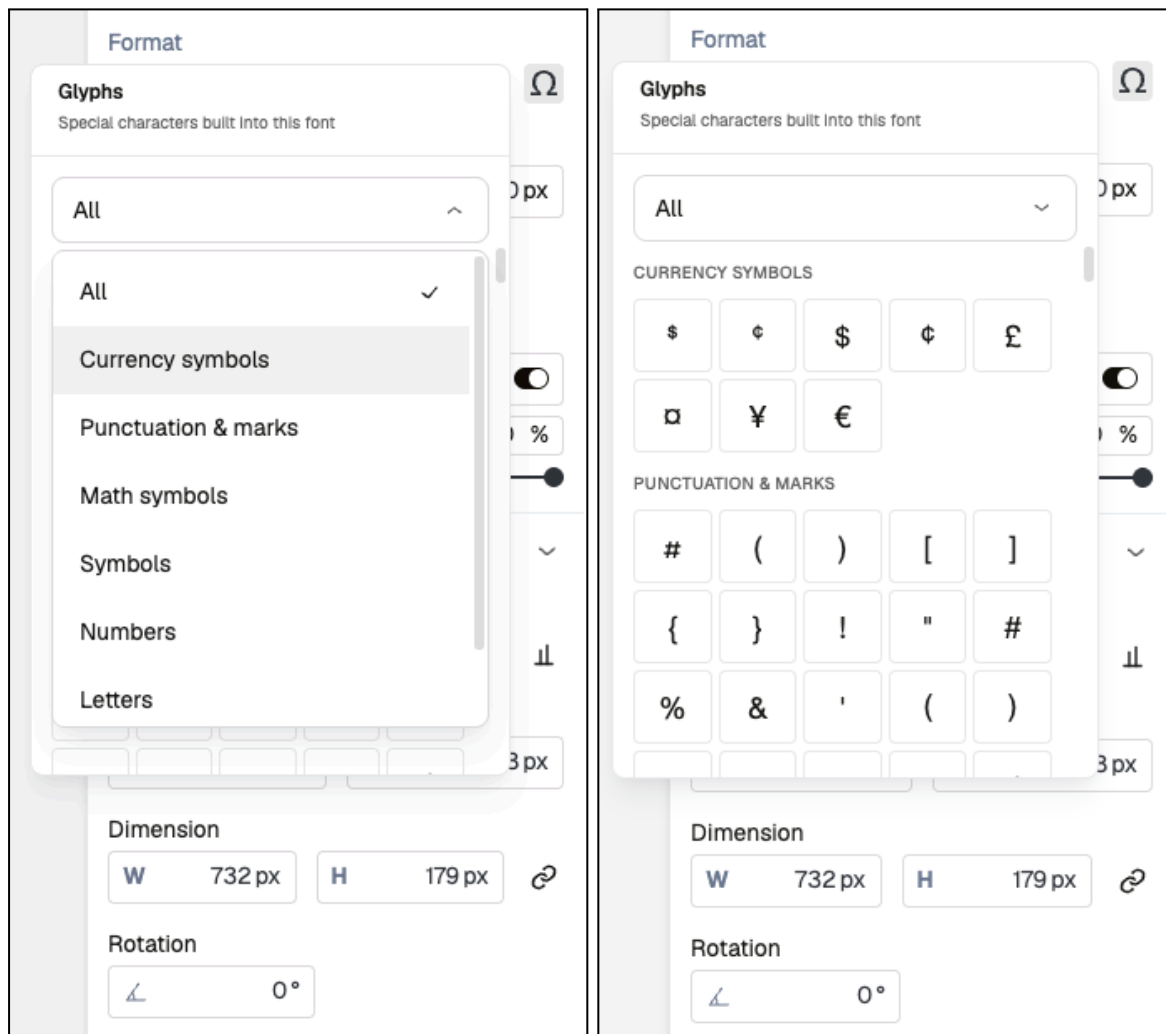

Brand library

Expand all | Collapse all

Category	Details	Created by
> Knowledge		
> Tones		
> Logos		
∨ Fonts · 15 items		
⋮ Font	HelveticaforTarget Default	Brennen Walsh
⋮ Font	HelveticaforTarget-Bold	Brennen Walsh
⋮ Font	HelveticaforTarget-LightItalic	Brennen Walsh
⋮ Font	HelveticaforTarget-MediumItalic	Brennen Walsh
⋮ Font	HelveticaforTarget-ThinItalic	Brennen Walsh

Text properties

Headline

HelveticaforTarget

56

Search

BRAND FONTS

HelveticaforTarget Default

HelveticaforTarget-Bold

HelveticaforTarget-LightItalic

HelveticaforTarget-MediumItalic

HelveticaforTarget-ThinItalic

HelveticaforTarget-Medium

HelveticaforTarget-Thin

Alignment

What's new

- **Glyph and symbol picker:** A picker in the text editor lets you insert or apply the active font's special glyphs without memorising shortcuts or copying and pasting.
- **Glyphs scoped to your font:** The picker shows the glyphs actually present in the font you're using, grouped into clear categories so they're easy to find.
- **Admin-controlled font ordering:** A workspace admin or creative can drag fonts into the order they want in Brand Library, so the brand's fonts sit at the top of the list in the editor.
- **Brand default font:** An admin can set a workspace default so newly created text starts in the brand font automatically. The default font is the one at the top of the list and has a "Default" tag shown next to it in Brand Library.
- **Fidelity through edits and export:** Applied special glyphs persist through further editing and are preserved on export across output formats.

Why it matters

- **On-brand without leaving Pencil:** Produce brand-compliant typography directly in the editor. No need to treat Pencil as a first draft that gets corrected in another program like Photoshop.
- **Fewer manual steps and less memorisation:** Removes the need for copy/paste, shortcut-memorising, and repeated font selection.
- **Consistent by default:** New text starts in the right font from the first keystroke, so staying on-brand isn't a manual step.
- **Reusable for any brand:** The controls are built generically, so any brand with a custom font and typography standards can configure its own fonts, ordering, default, and glyphs the same way.

Who it's for

- Admins, Creatives or anyone who can edit brand library fonts or use the Pencil editor across all Pencil customers.

What this unlocks

These Advanced Typography capabilities turn a process with a manual correction pass into a single in-editor flow, letting brand teams place their font's special characters, order their fonts, and default to the right one automatically, while keeping every applied glyph intact through editing and export.

Give it a try and let us know what you think! 🚀